

mSi

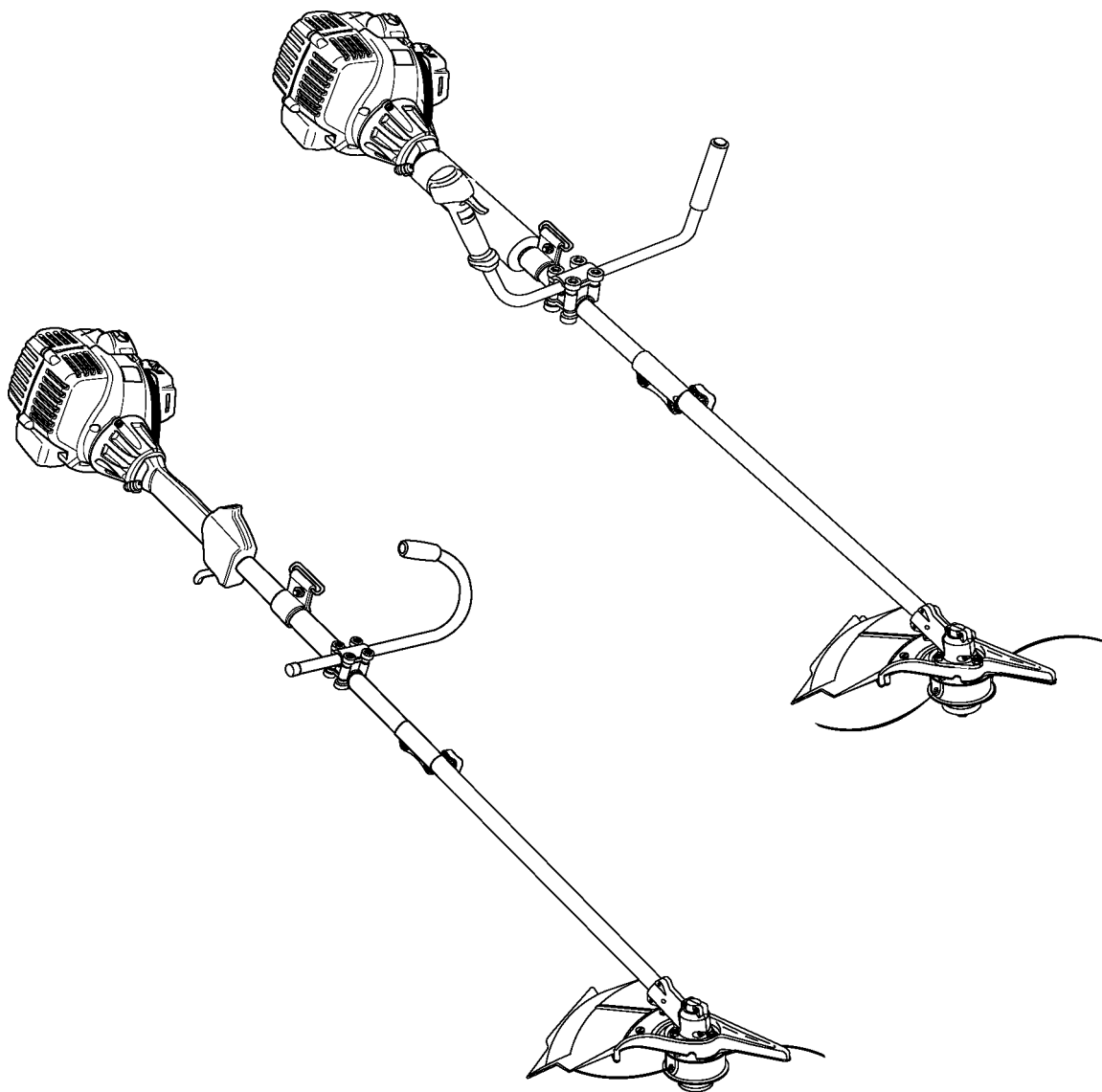

H12
FORM NO. 769-08350

MTD Products Aktiengesellschaft • Saarbrücken • Germany

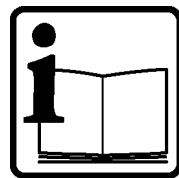

Srpski

[Í5

Pycc

[Í6|

apc

[Í0I

Eesti

Ûial

Lietuviskai

4 |

Latviesu valoda

Ma e o c

sr UPOZNAJTE SVOJ APARAT
 ru C
 bg CE C
 et ÖPPIGE OMA SEADET TUNDMA
 lt SUSIPAZINKITE SU ĮRENGINIŲ
 lv IEPAZĪSTĪTIETIES AR JŪSU IERĪCI
 mk

Typ 1

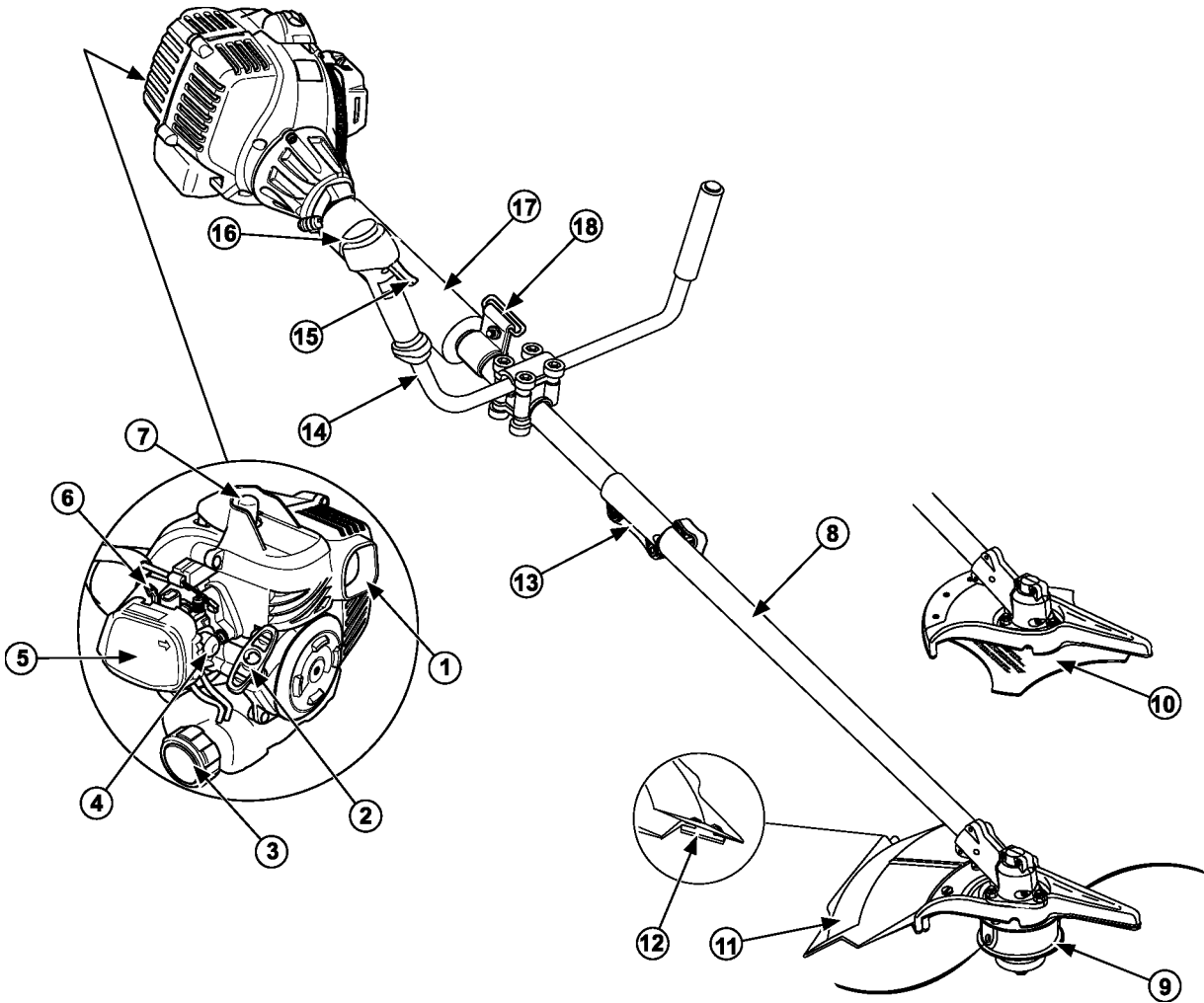

sr
ru
bg
et
lt
lv
mk

UPOZNAJTE SVOJ APARAT

C

CE C

ÖPPIGE OMA SEADET TUNDMA

SUSIPAZINKITE SU RENGINIŲ

IEPAŽĪSTĪETIES AR JŪSU IERĪCI

Typ 2

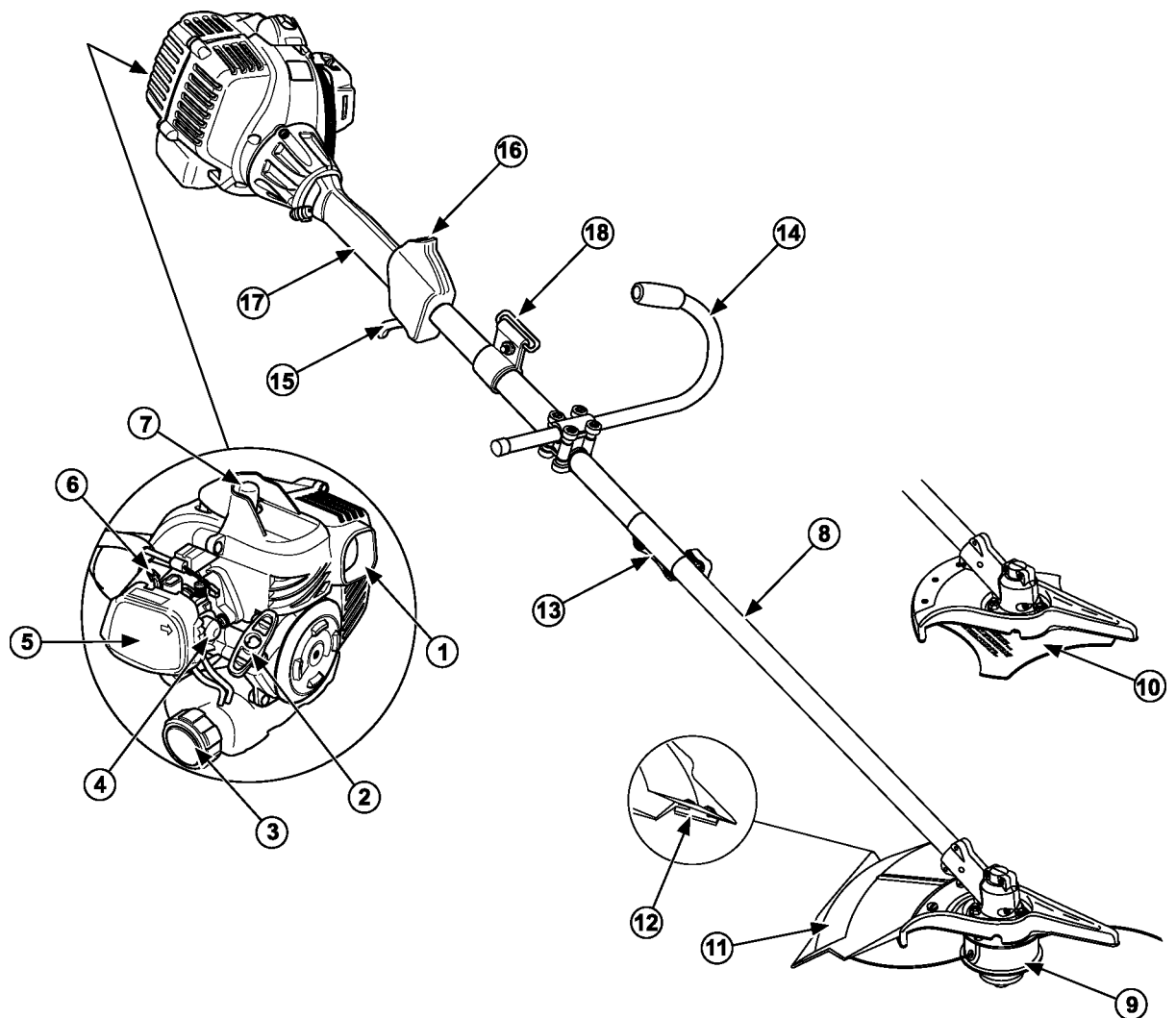

Opis delova

- | | |
|---------------------------------|--------------------------------|
| 1. Izdovna cev | 10. Secivo za rezanje |
| 2. Rucica startera | s poklopcem * |
| 3. Poklopac rezervoara | 11. Poklopac umetka za rezanje |
| 4. Usisna pumpa/rucna pumpa | 12. Secivo za rezanje konca |
| 5. Poklopac vazdusnog filtra | 13. EZ-Link™ * |
| 6. Poluga prigusivaca vazduha * | 14. Rucka |
| 7. Svecica za paljenje | 15. Poluga za gas |
| 8. Cevasta drska | 16. Prekidac za paljenje |
| 9. Kalem s koncem | 17. Rucica |
| | 18. Drzac naramenika |

* zavisno od modela

- | | | |
|-----|------------|---|
| 1. | 10. | |
| 2. | | |
| | 11. | |
| 3. | 12. | - |
| | | |
| 4. | 13. | |
| () | EZ-Link™ * | |
| 5. | 14. | |
| | 15. | - |
| 6. | | |
| | * 16. | |
| 7. | | |
| 8. | 17. | |
| 9. | - 18. | |

- | | | |
|-----|----------------|--|
| 1. | 11. | |
| 2. | | |
| 3. | 12. | |
| 4. | / | |
| | 13. EZ-Link™ * | |
| 5. | 14. | |
| | 15. | |
| 6. | * 16. | |
| 7. | 17. | |
| 8. | 18. | |
| 9. | | |
| 10. | | |

Osade kirjeldusi

- | | |
|----------------------|------------------------------|
| 1. Väljalase | 10. Lõiketera koos kattega * |
| 2. Starteri käepide | 11. Lõikemehhanismi kate |
| 3. Kütusepaagi kork | 12. Jõhvi lõiketera |
| 4. Kütusepump/primer | 13. EZ-Link™ * |
| 5. Õhufiltri kate | 14. Käepideme vars |
| 6. Õhuklapi hoob * | 15. Gaasihoob |
| 7. Süüteküüнал | 16. Süütelukk |
| 8. Vars | 17. Varre käepide |
| 9. Jõhvi pool | 18. Ölarihma kinnitus |
| * vastavalt mudelile | |

Daliq aprasymas

- | | |
|-----------------------------------|-----------------------------|
| 1. Ismetimo vamzdis | 10. Gelezte su gaubtu * |
| 2. Starterio rankenele | 11. Pjovimo priedo gaubtas |
| 3. Bako kamStis | 12. Siulo nupjovimo geleZte |
| 4. Isiurbimo siurblys/paleidiklis | 13. EZ-Link™ * |
| 5. Oro filtro dangtelis | 14. Rankenos strypas |
| 6. Droselio svirtis * | 15. Akceleratoriaus svirtis |
| 7. Degimo zvake | 16. UZvedimo jungiklis |
| 8. Strypas | 17. Strypo rankena |
| 9. Siulo rité | 18. Peciu dirZo laikiklis |
| * priklausomai nuo modelio | |

Detaju apraksts

- | | |
|-----------------------------|----------------------------|
| 1. Izpludes caurule | 11. Griezejuzliktna nosegs |
| 2. Startera rokturis | 12. Pavediena |
| 3. Tvertnes vaks | griezejasmens |
| 4. Uzsûcejsûknis/sûknTtis | 13. EZ-Link™ * |
| 5. Gaisa filtra vaks | 14. Roktura stienis |
| 6. Droseles svira * | 15. Akseleratora svira |
| 7. Aizdedzes svece | 16. Aizdedzes sledzis |
| 8. Kats | 17. Siena rokturis |
| 9. Pavedienspole | 18. Plecu siksnas |
| 10. Griezejasmens ar nosegu | nostiprinajums |
| * atkarTba no modela | |

- | | | |
|-----|-----|----------------|
| 1. | 11. | |
| 2. | ^ | |
| 3. | | 12. |
| 4. | ^ / | |
|) | | 13. EZ-Link™ * |
| 5. | | 14. |
| | | 15. |
| 6. | * | 16. |
| 7. | | 17. |
| 8. | | 18. |
| 9. | | - |
| 10. | | |

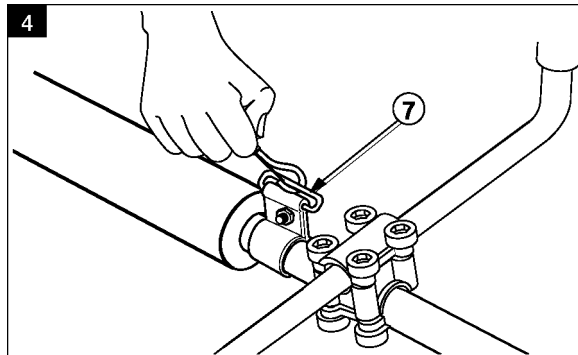
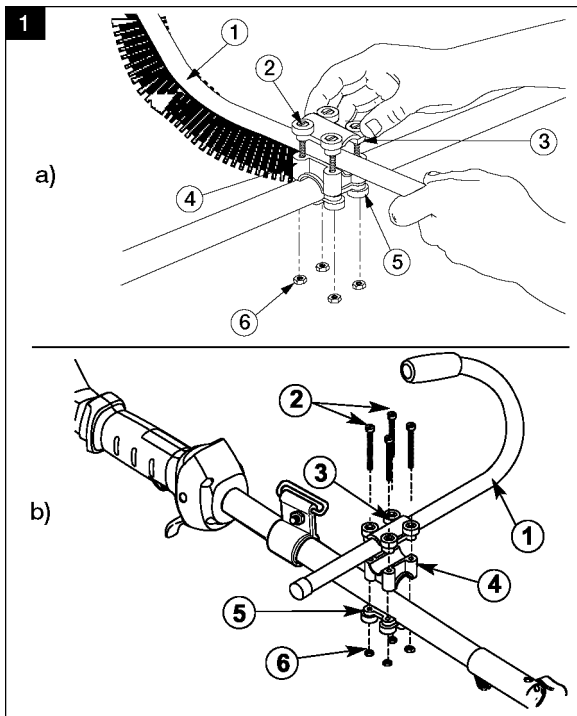

Opis delova - sl. 1-4

- | | |
|----------------------|-----------------------------|
| 1. Rucka | 5. Donja stezaljka |
| 2. Zavrtanj | 6. Navrtka |
| 3. Gornja stezaljka | 7. Brzodejstvujuci zatvaraC |
| 4. Srednja stezaljka | |

- . 1-4

- | | |
|----|----|
| 1. | 5. |
| 2. | 6. |
| 3. | 7. |
| 4. | |

- . 1-4

- | | |
|----|----|
| 1. | 5. |
| 2. | 6. |
| 3. | 7. |
| 4. | |

Osade kirjeldus - joon. 1-4

- | | |
|---------------------|--------------------|
| 1. Käepide | 5. Alumine klamber |
| 2. Kruvi | 6. Mutter |
| 3. Ulemine klamber | 7. Aas |
| 4. Keskmine klamber | |

Daliq aprasymas - 1-4 pav.

- | | |
|-----------------------|---------------------|
| 1. Rankena | 5. Apatinis gnybtas |
| 2. Varztas | 6. VerZiÉ |
| 3. Virsutinis gnybtas | 7. Apkaba |
| 4. Vidurinis gnybtas | |

Detaju apraksts - 1.-4. att.

- | | |
|--------------------|----------------------|
| 1. Roktura stienis | 5. Apakseja spaile |
| 2. Skruve | 6. Uzgrieznis |
| 3. Augseja spaile | 7. ÁtrdarbTbas slegs |
| 4. Videja spaile | |

- . 1-4

- | | |
|----|----|
| 1. | 5. |
| 2. | 6. |
| 3. | 7. |
| 4. | |

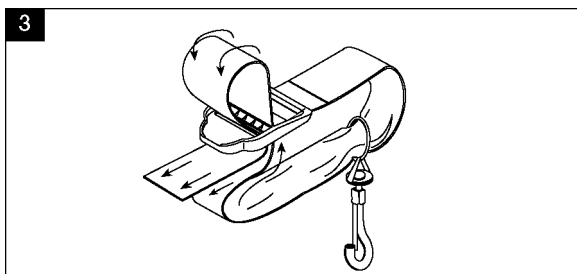
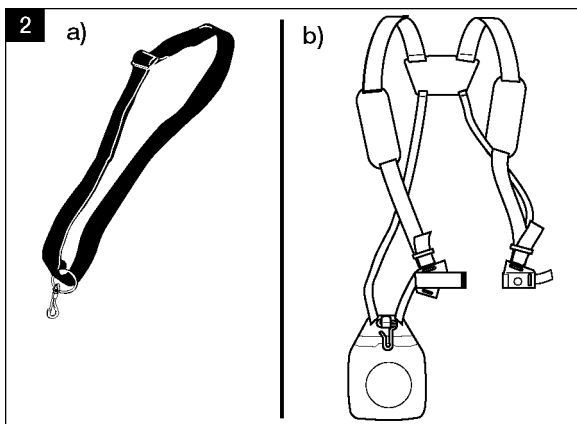

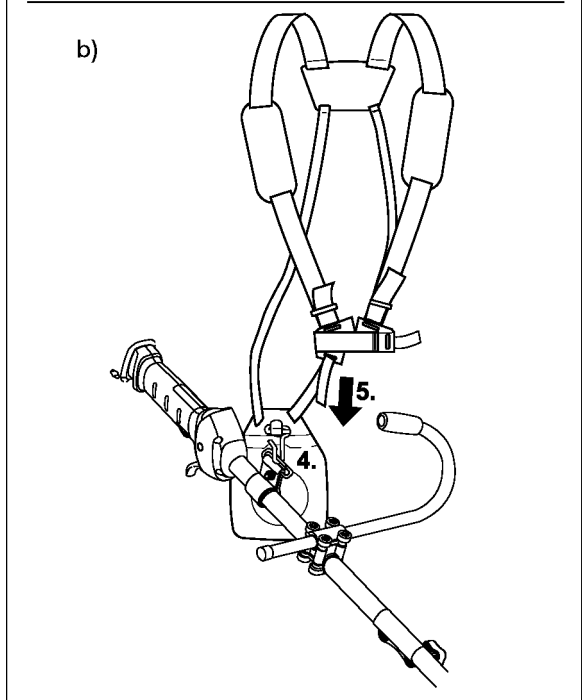
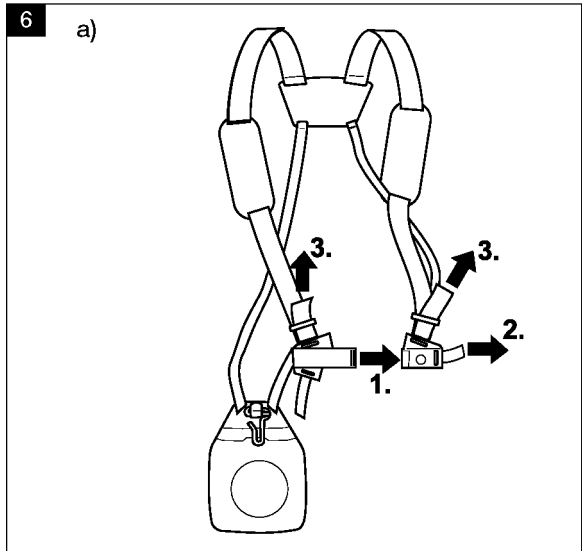
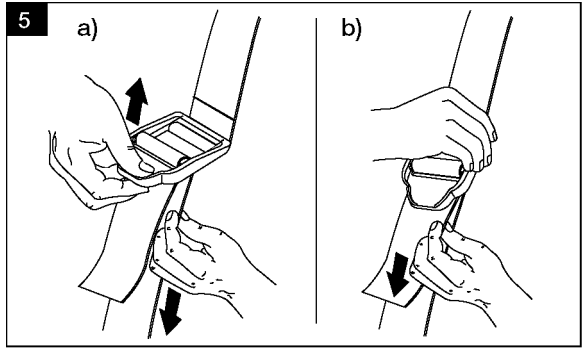

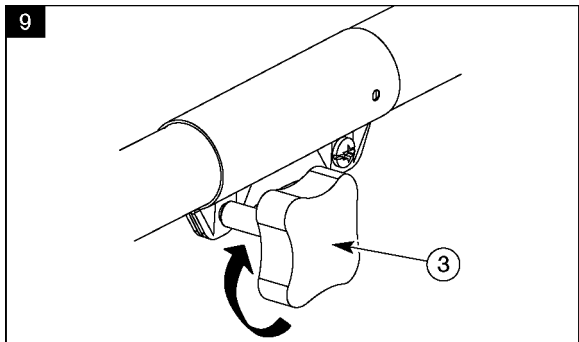
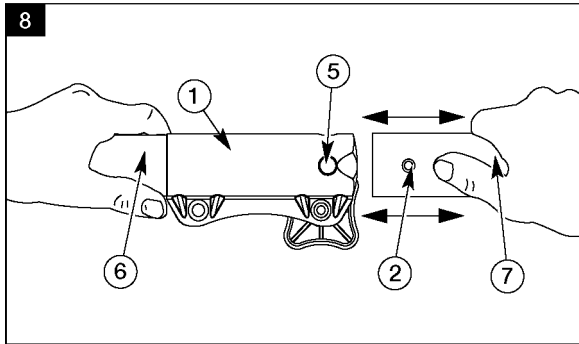
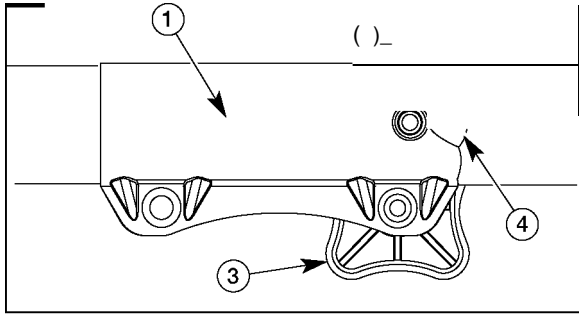

2 1 od izvedbe - 1 delova - !. 7-9

1. 7-11 TM
2. Okidno dugme
- 3.
4. Vodeci !
5. 0! 1 otvor
6. 0] vratila
7.] v atila

- . 7-9

1.

2- TM

2.

3.

4.

- . 7-9

1. 2-11 TM

2.

3.

Vaštava!t mude!!e - O8ade k! je!du8 -] . 7-9

1. 7-11 TM
2. Vabastus upp
- 3.
4. Juhtsuve d
- 5.
6. V llitoru 1 8
7. V llitoru 1 8

!! 8 ! konstrukcijas - !! § 8 - 7-9 pav.

1. 7-11 TM
2. ij] 1 mygtuka8
3. !
4. 1 1 8|8 1 !18
5. 1 1 8 !
6. Vir8utini8 gofruota8i8 2 18
7. Apatini8 gofruota8i8 2 18

Atka 'iba modeja - Detaju ap ak8t8 - 7-9. att.

1. 7-11 TM
2. ! 1 8 8
- 3.
4. 1
5. 0 ! 18 8
6. 8] !
7. 8] !

- . 7-!

1. 2-11 TM

2.

3.

4.

5.

6.

7.

Opis delova - sl. 10-13

- | | |
|--------------------------------------|-------------------------------|
| 1. Zastitni lim na umetku za rezanje | 6. KuCiste pogonskog vratila |
| 2. Zavrtnji | 7. Prorez za sigurnosnu sipku |
| 3. Ucvrscenje zastitnog lima | 8. Rupa na kosuljici vratila |
| 4. Sigurnosna sipka | 9. Umetak za rezanje |
| 5. Pogonsko vratilo | 10. DrzaC seCiva |

- . 10-13.

- | | |
|----|-----|
| 1. | 7. |
| 2. | 8. |
| 3. | 9. |
| 4. | 10. |
| 5. | - |
| 6. | - |

- . 10-13

- | | |
|----|-----|
| 1. | 6. |
| | 7. |
| | 8. |
| | 9. |
| | 10. |

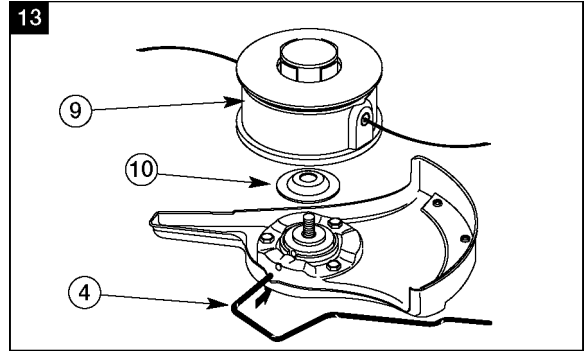
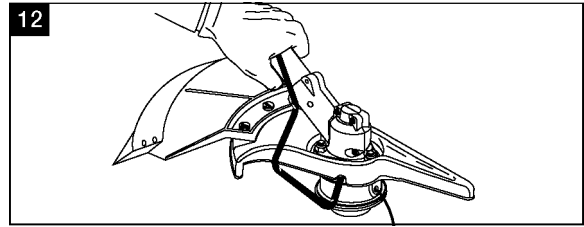
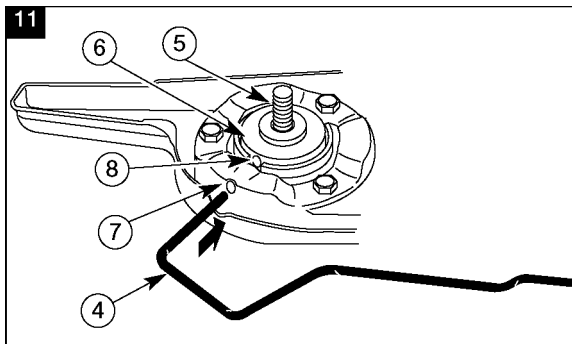
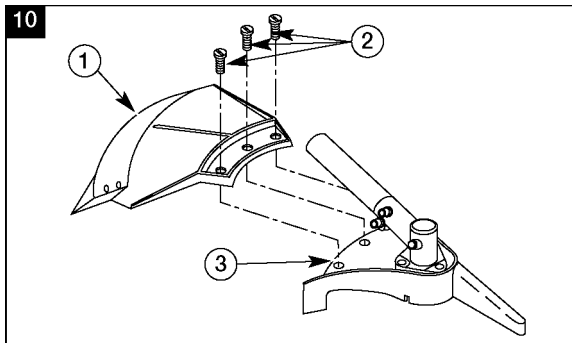

Osade kirjeldus - joon . 10 13

- | | |
|------------------------------|----------------------|
| 1. Trimmikaitse | 6. AjamivSlli korpus |
| 2. Kruvid | 7. Lukustusvarda ava |
| 3. Kaitseplaadi kinnitusalus | 8. VSllipuksi ava |
| 4. Lukustusvarras | 9. Trimmipea |
| 5. AjamivSll | 10. Terahoidik |

Daliq aprasymas - 10- -13 pav.

- | | |
|---|------------------------------|
| 1. Pjovimo antgalio apsauginis skydelis | 6. Pavaros veleno korpusas |
| 2. Varztai | 7. IsdroZa blokavimo strypui |
| 3. Apsauginio skydelio tvirtinimas | 8. Veleno [déklo] anga |
| 4. Blokavimo strypas | 9. Pjovimo antgalis |
| 5. Pavaros velenas | 10. Peilio laikiklis |

Detalu apraksts - 10- 13. att.

- | | |
|-----------------------------------|-----------------------------------|
| 1. Griezejuzliktna aizsargvairogs | 6. Primaras varpstas korpus |
| 2. Skruves | 7. DrosTbas stiena sprauga |
| 3. Aizsargvairoga nostiprinajums | 8. Varpstas starpdetalias caurums |
| 4. DrosTbas stienis | 9. Griezejuzliktnis |
| 5. Primara varpsta | 10. Asmens nostiprinajums |

- . 10- 13

- | | |
|----|-----|
| 1. | 6. |
| | 7. |
| 2. | 8. |
| 3. | 9. |
| 4. | 10. |
| 5. | - |

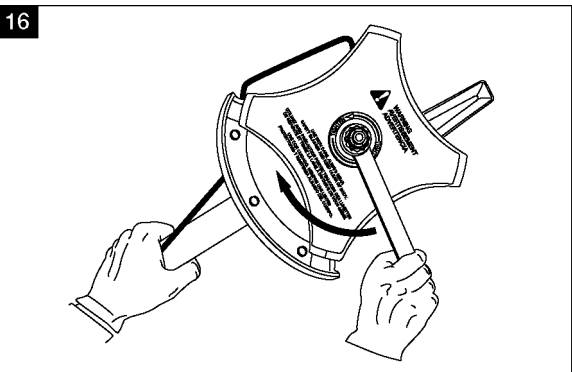
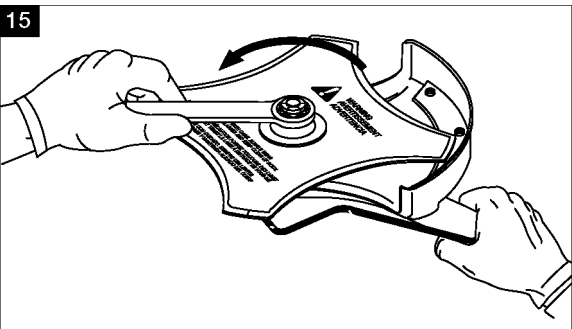
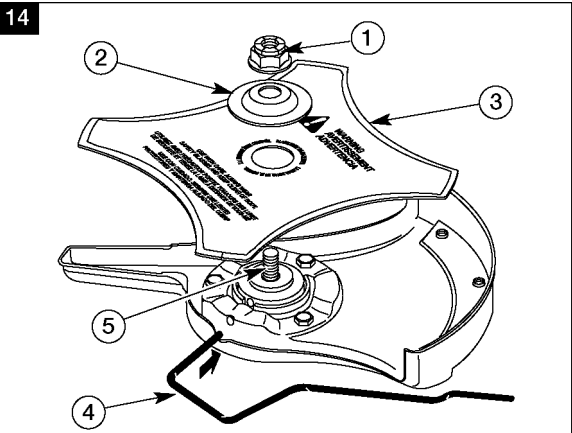

Opis delova - sl. 14-16

- | | |
|----------------------|------------------------------|
| 1. Navrtka | 4. Sigurnosna sipka |
| 2. Dr^ac seciva | 5. Kuciste pogonskog vratila |
| 3. SeCivo za rezanje | |

- . 14-16.

- | | |
|----|----|
| 1. | 4. |
| 2. | 5. |
| 3. | |

- . 14-16

- | | |
|----|----|
| 1. | 4. |
| 2. | 5. |
| 3. | |

Osade kirjeldus - jeon. 14-16

- | | |
|---------------|----------------------|
| 1. Mutter | 4. Lukustusvarras |
| 2. Terahoidik | 5. AjamlvSiii korpus |
| 3. LSiketera | |

Daliq aprasymas - 14-16 pav.

- | | |
|---------------------|----------------------------|
| 1. Verzle | 4. Blokavimo strypas |
| 2. Peilio laikiklis | 5. Pavaros veleno korpusas |
| 3. Peilis | |

Detaju apraksts - 14.- 16. att.

- | | |
|----------------------------|-----------------------------|
| 1. Uzgrieznis | 4. DrosTbas stienis |
| 2. As me ns nostiprinajums | 5. Primaras varpstas korpus |
| 3. Griezejasmens | |

- . 14-16

- | | |
|----|----|
| 1. | 4. |
| 2. | 5. |
| 3. | |

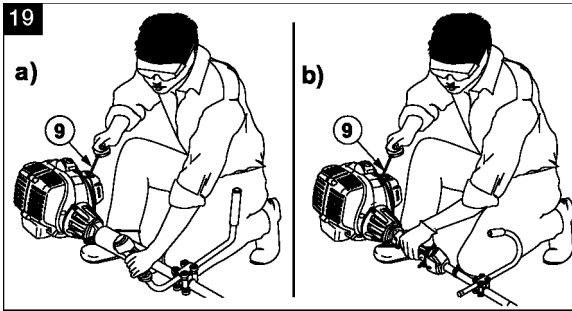
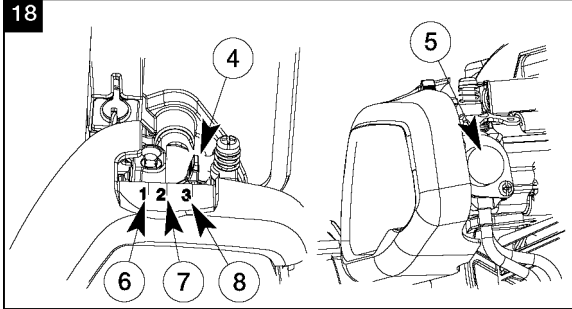
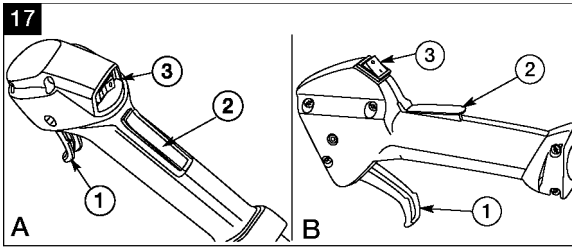

Opis delova - sl. 17-19

- | | |
|--|---------------------------------|
| 1. Poluga za gas | 6. Radni položaj (3) * |
| 2. Utvrdivac poluge za gas * | 7. Poluga prigusivaCa vazduha * |
| 3. Prekidac za paljenje | 8. Usisna pumpa/ ruCna pumpa |
| 4. Maksimalni položaj prigusivaCa vazduha (1) * | 9. Uze startera |
| 5. Srednji medupoložaj prigusivaCa vazduha (2) * | |
- * Zavisno od izvedbe

- . 17 19

- | | | |
|----|----|---------|
| 1. | 5. | : « |
| 2. | | » (2) * |
| | 6. | - |
| 3. | | : « |
| | | » (3) * |
| 4. | 7. | . |
| | 8. | * |
| | 9. | / |

- . 17-19

- | | | |
|----|-------|-----|
| 1. | 6. | (3) |
| 2. | 7. | * |
| | 8. | / |
| 3. | | |
| 4. | (1) * | 9. |
| 5. | - | |
| | (2) * | |

Osade kirjeldus - joon. 17- 19

- | | |
|---|---------------------|
| 1. Gaasihoob | 6. Toosend (3) * |
| 2. Gaasihoova lukk * | 7. Ohuklapi hoob * |
| 3. Süütelüliti | 8. Taitepump/primer |
| 4. Ohuklapp kinni (1) * | 9. Starterinoor |
| 5. Ohuklapp poolkinni, vahepealne asend (2) * | |
- * Soltuvalt mudelist

Daliq aprasymas - 17-19 pav.

- | | |
|--|--|
| 1. Akceleratoriaus rankinio valdymo rankenélé | 5. Tarpiné sklendés padétis (2) * |
| 2. Akceleratoriaus rankinio valdymo rankenélés fiksatorius * | 6. Darbo padétis (3) * |
| 3. Uzdegimo jungiklis | 7. Oro sklendés valdymo svirtis * |
| 4. Visiskai uZdaryta sklendé (1) * | 8. [leidziamasis siurblys/ paleidiklis |
| | 9. Starterio paleidimo lynas |
- * Priklausomai nuo modelio

Detaju apraksts -17-19. att.

- | | |
|------------------------------------|---------------------------------------|
| 1. Akseleratora svira | 5. Videja droseles starpozTcija (2) * |
| 2. Akseleratora sviras fiksators | 6. Darba rezTma pozTcija (3) * |
| 3. Aizdedzes sledzis | 7. Droseles svira * |
| 4. PilnTga droseles pozTcija (1) * | 8. UzsQcejsQknis/suknTtis |
| | 9. Palaides trosé |
- * AtkarTbá no modela

- . 17- 19

- | | | |
|----|--------|-------|
| 1. | 6. | (3) * |
| 2. | 7. | * |
| | 8. | / |
| 3. | |] |
| 4. | (1)*9. |] |
| 5. | | |
| | (2) * | |



21

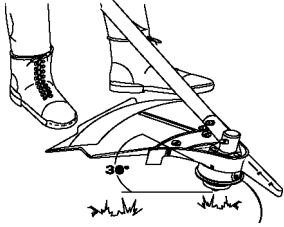
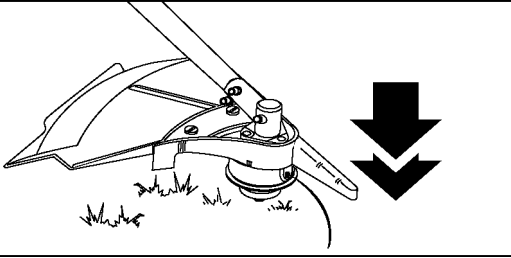

23

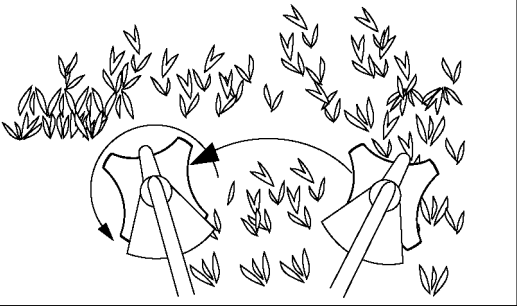

24

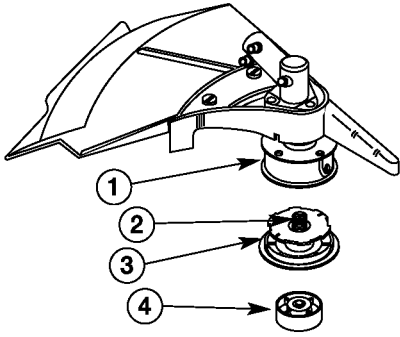

[8 delova - !. 24-26

- 1. Kuciste 1
- 2. 1
- 3. 1
- 4. Pritisno
- 5. 2 1

- 1.
- 2.
- 3.
- 4.
- 5.

- . 24-26

- 1.
- 2.
- 3.
- 4.
- 5.

Osade kirjeldus -] . 24-26

- 1. !1
- 2. !
- 3. !
- 4. Vajutu nupp
- 5.

- 24-26 .

- 1. Ritës
- 2. 8 !
- 3. Rit
- 4. Isgaubta !
- 5. 1 1]1 !

1 | 1 - 24-26. 11.

- 1. 8 !
- 2. At pe e
- 3. 8 !
- 4. 1 1
- 5. 8 2 2 1

- . 24-26

- 1.
- 2.
- 3.
- 4.
- 5.

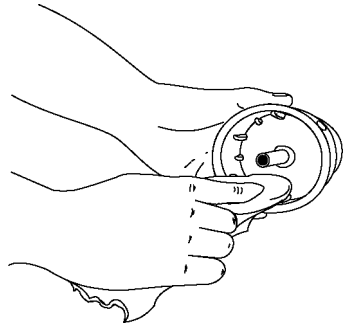

26

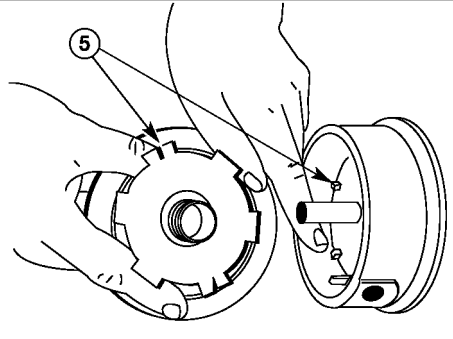

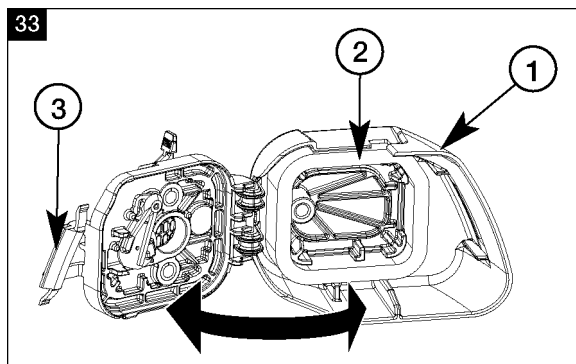
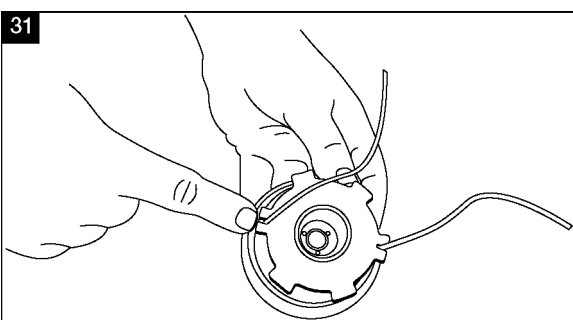
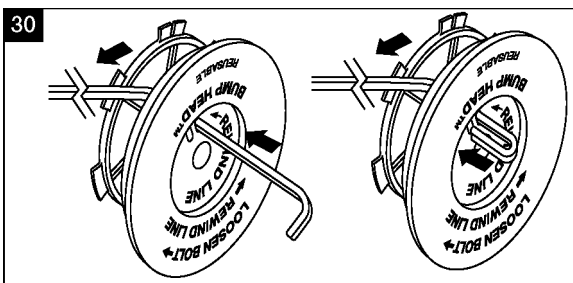
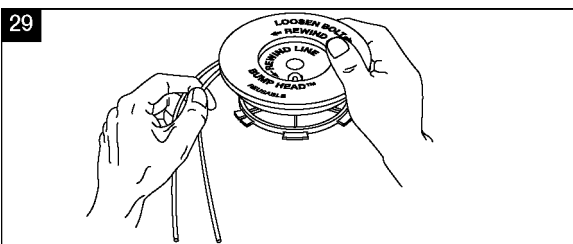
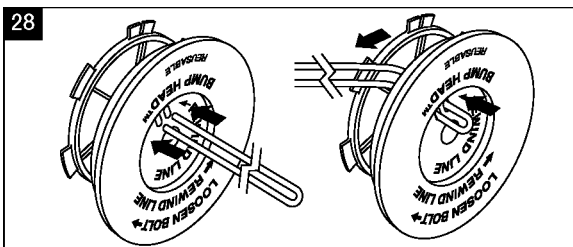
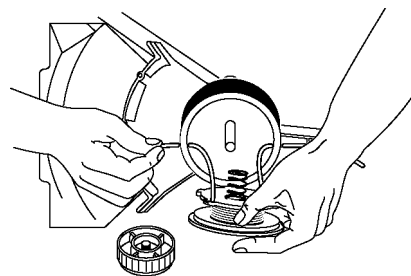
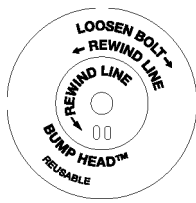
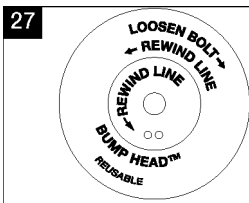

Opis delova - sl. 33

1. Poklopac vazdusnog filtra 3. Pricvrсна vezica
2. Vazdusni filter

- . 33

1. 3.

2.

- . 33

1. 3.

2.

Osade kirjeldus -] . 33

1. Ohufiltri kaas 3. Kinnitusaas
2. Ohufilter

Daliq aprasymas - 33 pav.

1. Oro filtro dangtelis 3. Laikancioji tvarslė
2. Oro filtras

Detaju apraksts - 33. att.

1. Gaisa filtra vaks 3. Turetajsaisstenis
2. Gaisa filtrs

- . 33

1. Kana® 3. ^

2.

Opis delova - sl. 37-38

1. Poklopac vazdusnog filtra

2. Regulator broja obrtaja pri praznom hodu

3. Svecica za paljenje

- . 37-38

1. 3.

2.

- . 37-38

1. 3.

2.

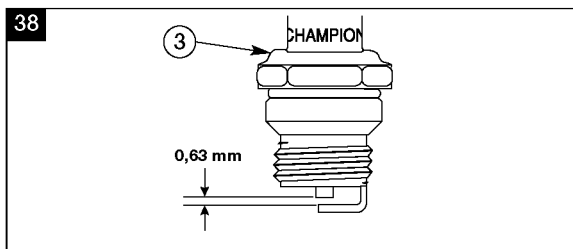
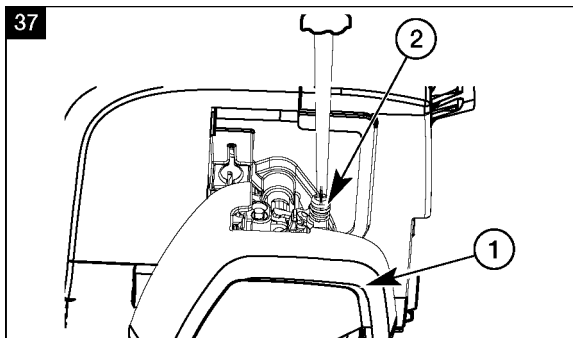
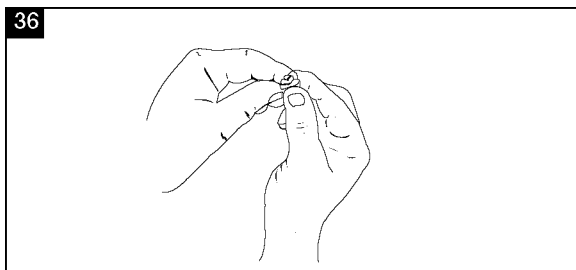
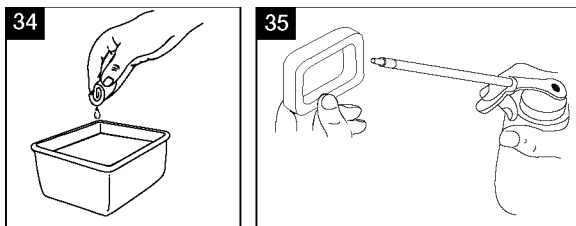

Osade kirjeldus - joon. 37-38

1. Ohufiltri kaas
2. Tuhikäigupoorete regulaator
3. Suutekuunal

Daliq aprasymas - 37-38 pav.

1. Oro filtro dangtelis
2. Tusciosios eigos reguliavimo varZtas
3. Uzdegimo zvake

Detaju apraksts - 37.-38. att.

1. Gaisa filtra vaks
2. Apgriezienu skaita tuksgaita regulators
3. Aizdedzes svece

- . 37-38

1. Kana® 3.

2.

2,41

16

(
.)

15

:

, a ero

:

()

)

(

/

10

().

12,7

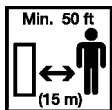

15



/ (« »)

/ (« »)

!

:

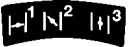

- 1•
- 2•
- 3•



85

85 (

>15%)

no

1- 1 ™

1. (. . .1).

2. (4)

:

3. 1. (. . .6),

2. (. . .7)

3.

4. (. . .8).

()

()

5. 1. (. . .7),

(. . .20), 2. (. . .8).

()

6. :

(. . .7)

(/)

3. (. . .9).

1. (. . .3).

2.

3.

(. . .4), (. . .5).

()

()

1. (. . .6). (3) (. . .10).

2.

3. / (. . .6).

4. (. . .6b). (3)

(. . .10).

) : ()

1. :
 (. .11).
 2. (. .12).
 3. (. .13).
 4. « (.) ».
 5. (. .14).
 6. (. .14).
 7. ,
 8. (. .11).
 9. (. .14).
 10. (. .15).

37

() 5/8.
 4-2
 (. .15).
 11.
 12.

) ()

1. .
 2. .
 3. (. .11).
 4. (. .12).
 5. () 5/8 (. .16).
 6. (. .11).
 7. (. .13).
 8. (.) « »).

2-
1 8 -3 (2-
« »).
/ 40:1 (2,5 %).

60).

92

-
-
-
-

10

().

/ 40:1 (2,5 %).

Starting Technology™,

Advanced

a

20

3.

AST

AST.

(. . 18).

3

1.

2.

. [1] (. . 17).

. [1].

4. 1 (. . 18). 2. 10-15

«1» (« »).

5. 1. (. . 17).

3 (. . 19). 2. (. [0]

6. 2 (. . 18). (. . 17).

7. 1 5 (. . 19).

8. 15-30 (. . 20).

9. (« »)(. . 18). 3

«2» (. . 18)

3-7. (. . 21)

. [I]

2.

25

3.

(3) - (8)

1. (. . 19).

:

(-)

:

(. . 20).
».

« »

«

:

(,).

•
•
•

20

•
•
•
•
•
•
•
•
•
•

(. . 23).

30

(. . 22).

:

:

(
8 !!!- !TM
8)

6. 7,3
(. .28).

7. (. .29).

(-)

: 8 111-11TM

2,41

11.

8. 8 !!!- !TM
3,65
(. .30).

9. 10

1. (. .24).

10. (. .16).

2. (. .24).

11. 15

3. (. .24).

12. (. .31).

4. (. .25).

13. (. .24).

5. (. .26).

8 111-11TM

. .27.

14. : c 6. 7.

1. c (. .24). (. .37).

2. (. .24). / CHAMPION

3. (. .24). RDJ7J

4. 0. 63. 50

5. 1.

6. : 2.

7. (. .32). 3.

(. .32). 4.

8. 5. (. .38). 0,63

6. 12,3 - 13,5

10

(. .33). (3) (1)

(. .33). (2) (. .33).

3. (. .34).

4. (SAE 30) (. .35).

5. (. .36).

5.

1.

2-x

2.

60

3.

30

2-

4.



« ».

« ».

10

[Redacted]

[Redacted]

[Redacted]

[Redacted]